

Product Specification Sheet

TS38 HYBRID

Metallic Asphalt Grey

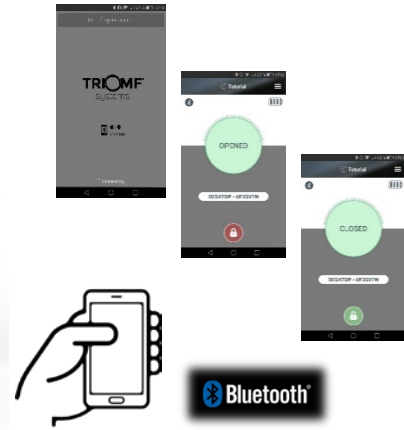

Dimensions	Outside S / M / L	Inside S / M / L
H (mm)	190	186
W (mm)	380	376
D (mm)	260 / 420 / 470	210 / 370 / 420
Capacity (l)	-	14,6 / 25,8 / 29,3

Technology

Operating System	Memory F-RAM last generation with Bluetooth 4.1
Opening & Closing	With keypad or Mobile device Bluetooth connection
Emergency opening	6 Digits Master Code via Bluetooth
Audit System	Last 250 events via Bluetooth.
Emergency opening with master key	Lock and Key of maximum security (exclusvie and patented)-

Product Specification Sheet

TS38 HYBRID

Metallic Asphalt Grey

General Features

Type of product	Electronic Safe with Bluetooth Technology
Laptop compatible S / M / L	No / 15,6" / 17"
Net Weight (Kg). S / M / L	12,0 / 14,0 / 15,0 Kg.
Gross Weight (Kg). S / M / L	12,5 / 14,5 / 15,5 Kg.
Keypad	ADA compliant rubber keypad
Display	TFT colour de 1,77" 128x160 LED
Interior LED light	White LED.
Locking system	Two 5x20 mm solid Stainless Steel bolts.
Door opening	Automatic with spring.
Power	4 AA batteries (included).
Low battery warning	Acoustic and visual
Inside Carpet	White leather lining with foam padding.
Colour	Metallic Asphalt Grey C4020020
Painting	Epoxi with polyester resins and metal particles
Door thickness	5 mm. Laser cutting frame and door.
Construction	Steel plate 1,5 mm. Folded and welded
Hinge	Right (open from the left to right)
Motor	Geared motor 6Vdc

Optional Equipment

RAL colour (*)

Left Hinge

Door Knob

Internal USB connection (**)

(*) Subject to availability and quantity..

(**) Available from January 2018

Designed and Manufactured in Spain

Triomf Systems S.L., as a consequence of its development and continuous improvement, reserves the right to introduce variations in the specifications and equipment of its products without prior notice.

TRIOMF, It is a registered trademark of Triomf Systems S.L. all other trademarks are the property of their respective owners

info@triomf-systems.com

www.triomf-systems.com

